

Kilovac S05LT - PC Mount Version Make & Break Load Switching

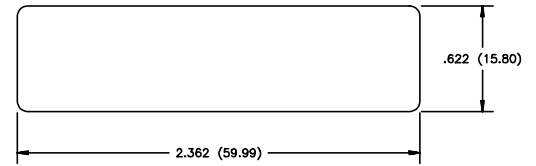
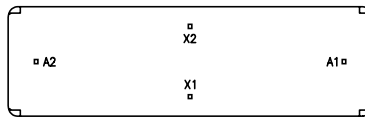
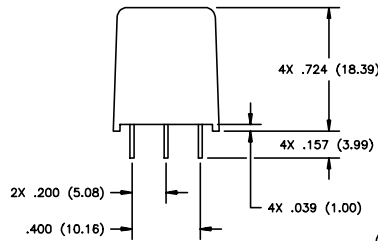
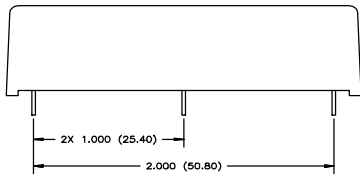
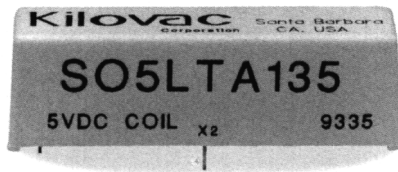

Features:

- Versatile 10kV, 5 amp carry relay
- Vacuum dielectric for power switching low current loads
- Widely used in test equipment applications
- Flying leads or PC mount available
- Very high service life

Kilovac S05LT - Flying Lead Version Make & Break Load Switching

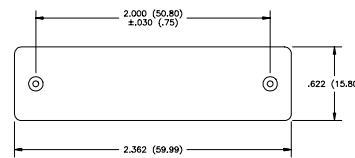
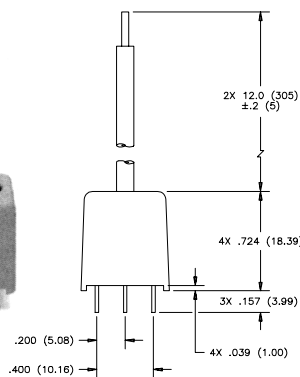
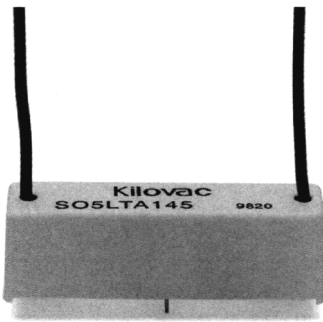

PIN VIEW/SCHEMATIC
(VIEWED FROM TOP OF RELAY)

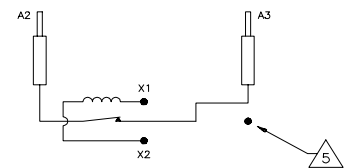

1. Overall dimensions are all maximums.
2. Dimensions in parentheses are in millimeters.
3. Pin dimensions tolerances are as follows:
Lengths: +/- .04 (1.0)
Spacing: +/- .006 (15)
4. Pins are .025 (0.6) square.
5. Coil terminals are polarity sensitive for the normally closed B version. X1 is positive, +, and X2 is negative -.

PRODUCT SPECIFICATIONS

Part Number	Unit	S05LTA	S05LTB
Contact Arrangement		SPST-NO	SPST-NC
Contact Form		A	B
Voltage Ratings Between Contacts	kV Peak	10	10
Current Carry @ DC	Amps	5	5
Load Switching		See Chart Below	See Chart Below
Contact Resistance	Ohms	0.250	0.250
Contact Capacitance	pF		
Between Open Contacts		1	1
Closed Contacts to Ground		8	8
Operate and Release Time [6]	ms	2	2
Shock, 11 ms 1/2 Sine (Peak)	G's	100	100
Vibration	G's Peak	20	20
.....	Hz	10 to 500	10 to 500
Temperature Range	°C		
Operating		-20 to +70	-20 to +70
Storage		-35 to +110	-35 to +110
Initial Insulation Resistance	GigaOhms	10	10
Mechanical Life	Cycles	1 billion	1 billion
Weight, nominal	oz.	1	1

COIL DATA

Nominal, Volts dc	5	12	24
Pickup, Volts dc, Maximum	6	15	28
Drop-Out, Volts dc	.5	2	4
Coil Resistance (Ohms ±10%)	28	150	780

PART NUMBER SELECTION

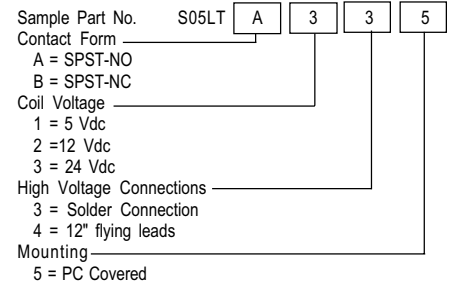

Load Switching		Life in Cycles
Voltage	Current	
110 Vac	0.5 Amps	1,000,000
120 Vac	1.0 Amps	200,000
1000 Vac	200 mAmps	100,000
5000 Vac	83 mAmps	1,000